

## SINGLE BIN ENCLOSURE

Designer: Spark - Aaron Tuck



### SLAT OPTIONS

- Oiled hardwood

### FRAME OPTIONS

- Hot dip galvanised mild steel

### FRAME FINISHES

- Powdercoated

### INSTALLATION

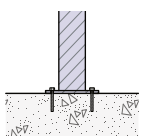

Bolt Down

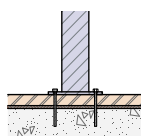

Bolt Through

### SIZES

- 85L
- 120L
- 240L

### FIXINGS

- 12mm fixings for 14mm Diameter holes

Alternative materials and finishes available on request

# GATEWAY SINGLE BIN ENCLOSURE

## SPECIFICATIONS - 85L

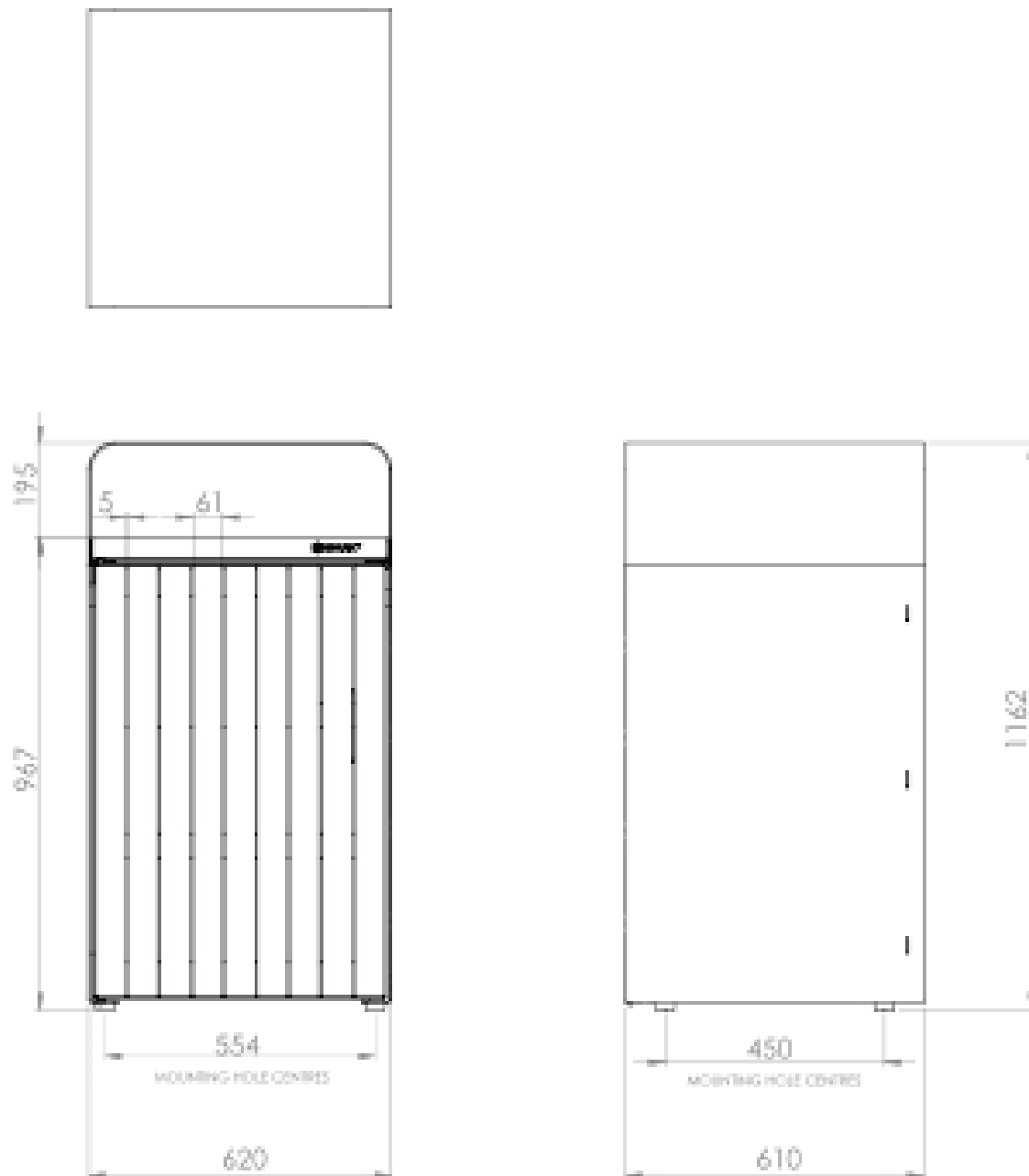

All measurements are in millimetres. Drawings are not to scale.  
Dimensions shown are for timber slat option.

PRODUCT CODE	FRAME FINISH	SLAT OPTION & SIZE (mm)
GAT001-ZIN-PC-S-T-85L	Powdercoated	61x19 Oiled hardwood timber

# GATEWAY SINGLE BIN ENCLOSURE

## SPECIFICATIONS - 120L

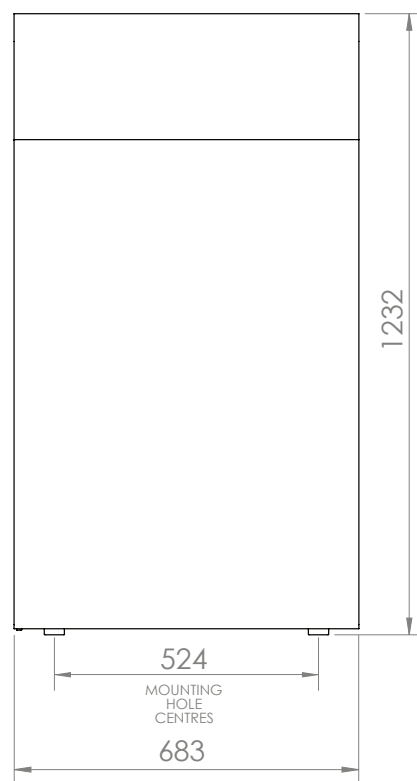
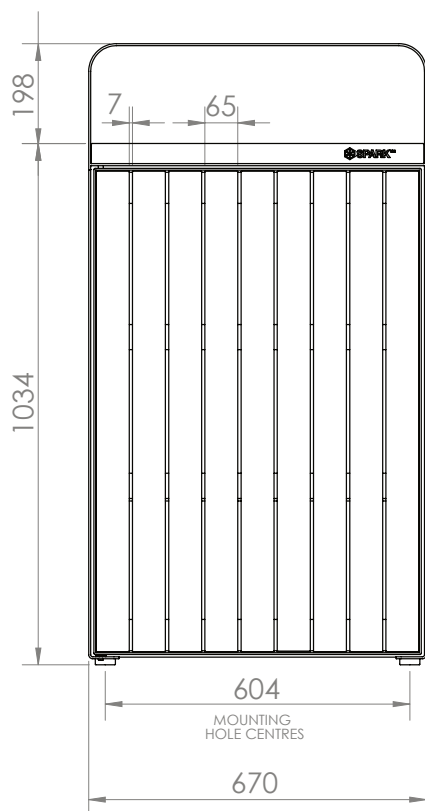
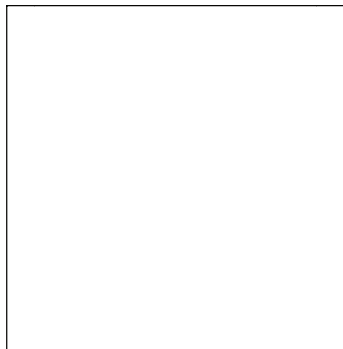

All measurements are in millimetres. Drawings are not to scale.  
Dimensions shown are for timber slat option.

### PRODUCT CODE

GAT001-ZIN-PC-S-T-120L

### FRAME FINISH

Powdercoated

### SLAT OPTION & SIZE (mm)

65x19 Oiled hardwood timber

# GATEWAY SINGLE BIN ENCLOSURE

## SPECIFICATIONS - 240L

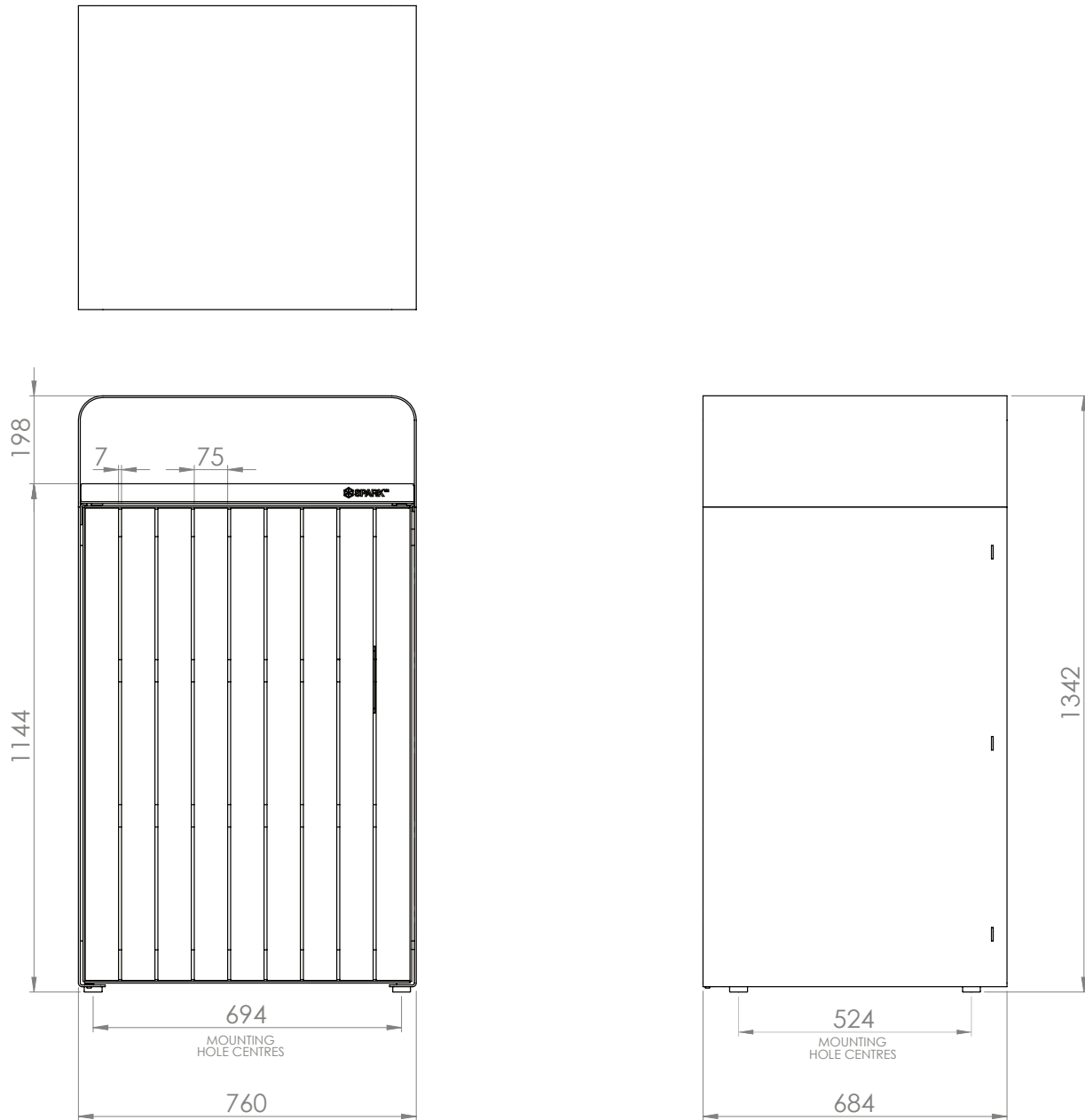

All measurements are in millimetres. Drawings are not to scale.  
Dimensions shown are for timber slat option.

PRODUCT CODE	FRAME FINISH	SLAT OPTION & SIZE (mm)
GAT001-ZIN-PC-S-T-240L	Powdercoated	75x19 Oiled hardwood timber